



Support for Walkway
Model: NAC000140

Area of use

The steel support for walkways is designed to provide sturdy and reliable structural support for walkways, catwalks, and platforms in various environments, including fish tanks. The steel support for walkways has undergone a hot galvanizing process to ensure durability and corrosion resistance. The hot-dip galvanizing procedure adheres to the standards outlined in DS/EN ISO 1461. Crafted from high-quality steel, this support system offers exceptional durability, and load-bearing capacity, making it ideal for supporting pedestrian traffic and equipment within aquatic settings. Key Features:

- High-strength steel construction
- Corrosion-resistant coating protects against rust
- Versatile design allows for easy installation
- Engineered to withstand heavy loads
- Designed to meet safety standards and regulations

Materials:

Hot galvanised steel – EN 10025-2/ EN ISO 1461-S355J2

Accessories:

NAC000140 Structure and Support legs for Walkways in between

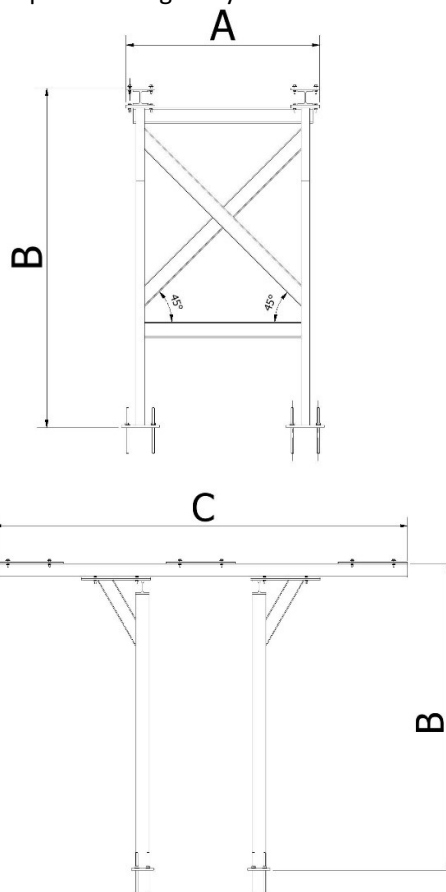

Product Specifications:

Product No.	A	B	C	Weight	Load Max
NAC000120	1270 mm	1200 mm	15.400 mm	970 kg	350 kg. pr. mtr.
NAC000130	1270 mm	1200 mm	18.310 mm	1.250 kg	350 kg. pr. mtr.
NAC000140	1270 mm	2210 mm	2.980 mm	260 kg	3.980 kg
NAC000150	1270 mm	2210 mm	1.280 mm	200 kg	3.980 kg